

Tank Connectors - PVC Back Nut Type

1/2" Tank Connector

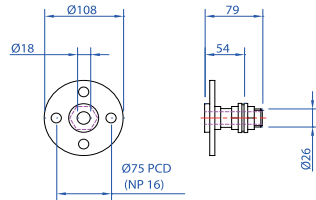

3/4" Tank Connector

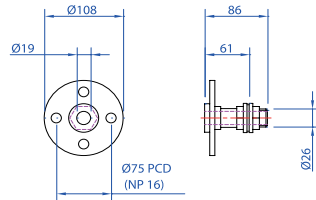

1" Tank Connector

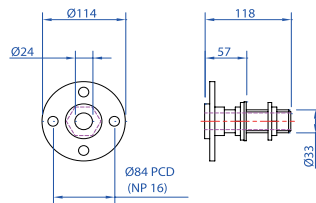

1.1/4" Tank Connector

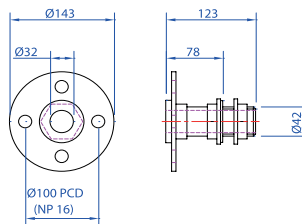

1.1/2" Tank Connector

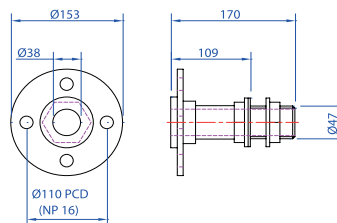

Standard duty back-nut type flanged connectors manufactured from PVC which are fitted to the tank with a hexagon nut inside and outside the tank wall. This type of tank connector is suitable for most applications. The range is available from 1/2" up to and including 4".

All supplied complete with EPDM gasket, stub flange and galvanized steel backing ring drilled to NP 16 configuration. The stub flange is supplied loose, requiring a solvent cement joint to be made by others.

Sizes 2" - 4" on page 2

Tank Connectors - PVC Back Nut Type

2" Tank Connector

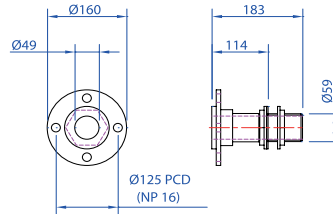

2.1/2" Tank Connector

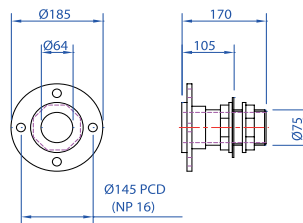

3" Tank Connector

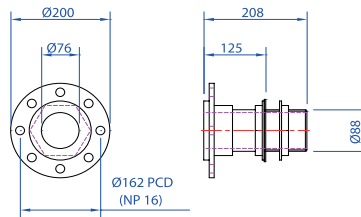
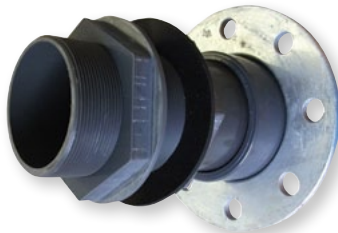

4" Tank Connector

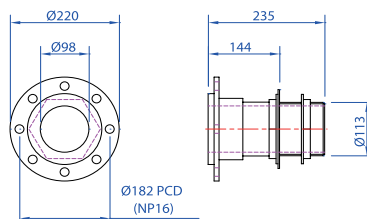
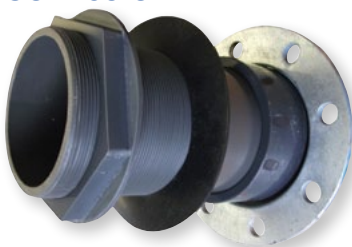

Standard duty back-nut type flanged connectors manufactured from PVC which are fitted to the tank with a hexagon nut inside and outside the tank wall. This type of tank connector is suitable for most applications. The range is available from 1/2" up to and including 4".

All supplied complete with EPDM gasket, stub flange and galvanized steel backing ring drilled to NP 16 configuration. The stub flange is supplied loose, requiring a solvent cement joint to be made by others.